



Dual Station Robotic Mig Welding Cells:

2 - Yaskawa MA1400 robots

Year: 2014

Hours: 10,000

High Capacity Automated Mig Welding

Automated Controls: Rexroth Indra Control VDP 40.3

SKS Q84 Weld controllers

Overall foot print: 20' x 18'

Cell opening: 12' x 90'

Fixture/Max part size: 3 meters

Integrated dust collection

Integrated fire suppression

Robots:

(2) - Yaskawa MA1400 Robots

Robot Controllers: DX100

Year: 2014

Weld positioners:

Yaskawa RWV2 Series - 2 station positioner w/ horizontal rotary axes

Station: 2

Axes: 2

Payload: 2500kg

Distance between faceplates: 3000mm

Welding Supply:

(2) SKS LSQ5 power supplies

Below is a link to weld supplies(2) - SKS LSQ5 power supplies

(2) SKS Torch systems: weld guns / PF5 power feeders

(2) Nasarc/J Thielmann Torch cleaners



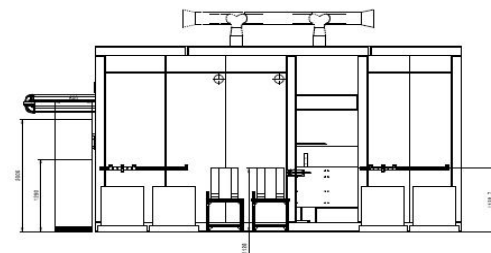
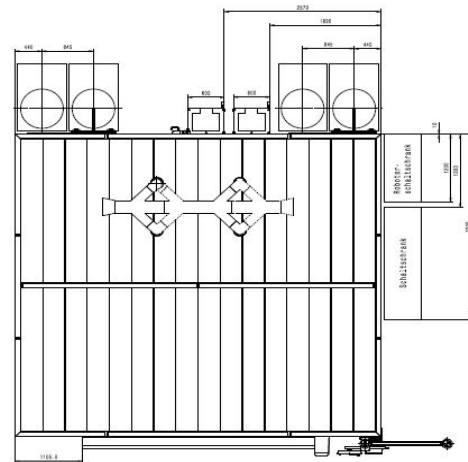
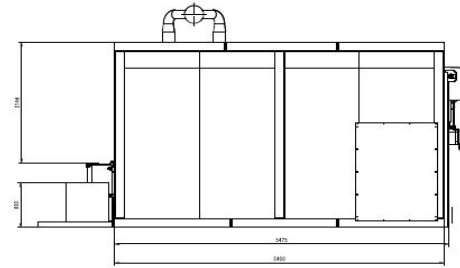
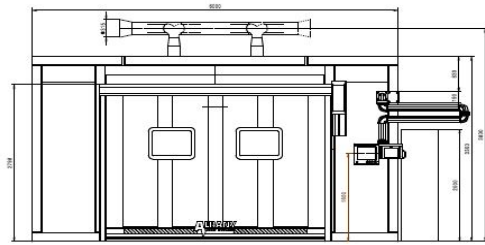
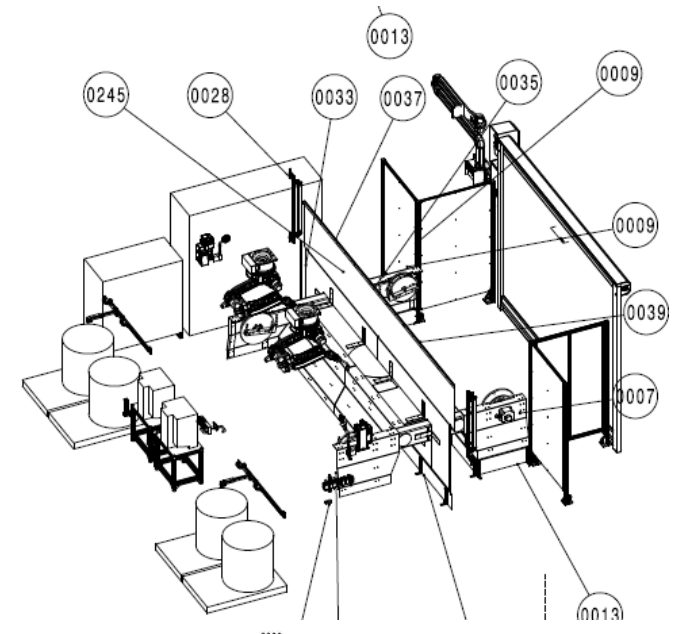
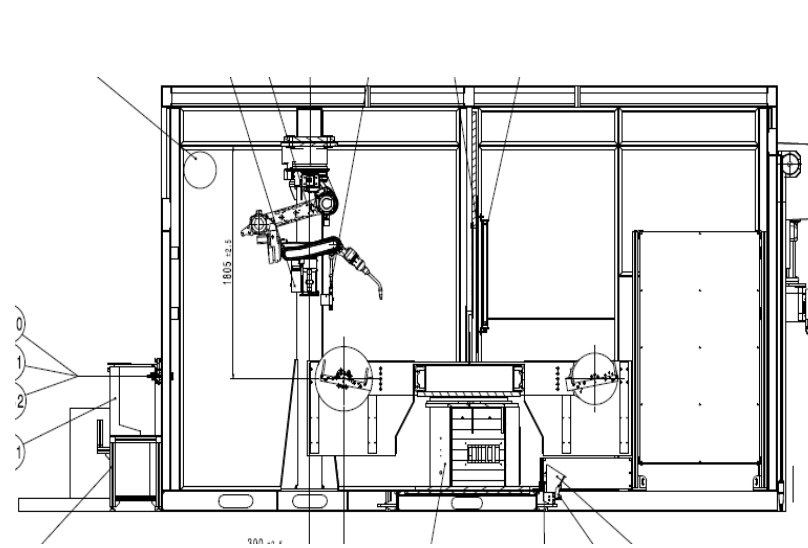

ANSCHLUSS
G 1/2" (LUFT)

